

# FLUIDICS SOLUTIONS

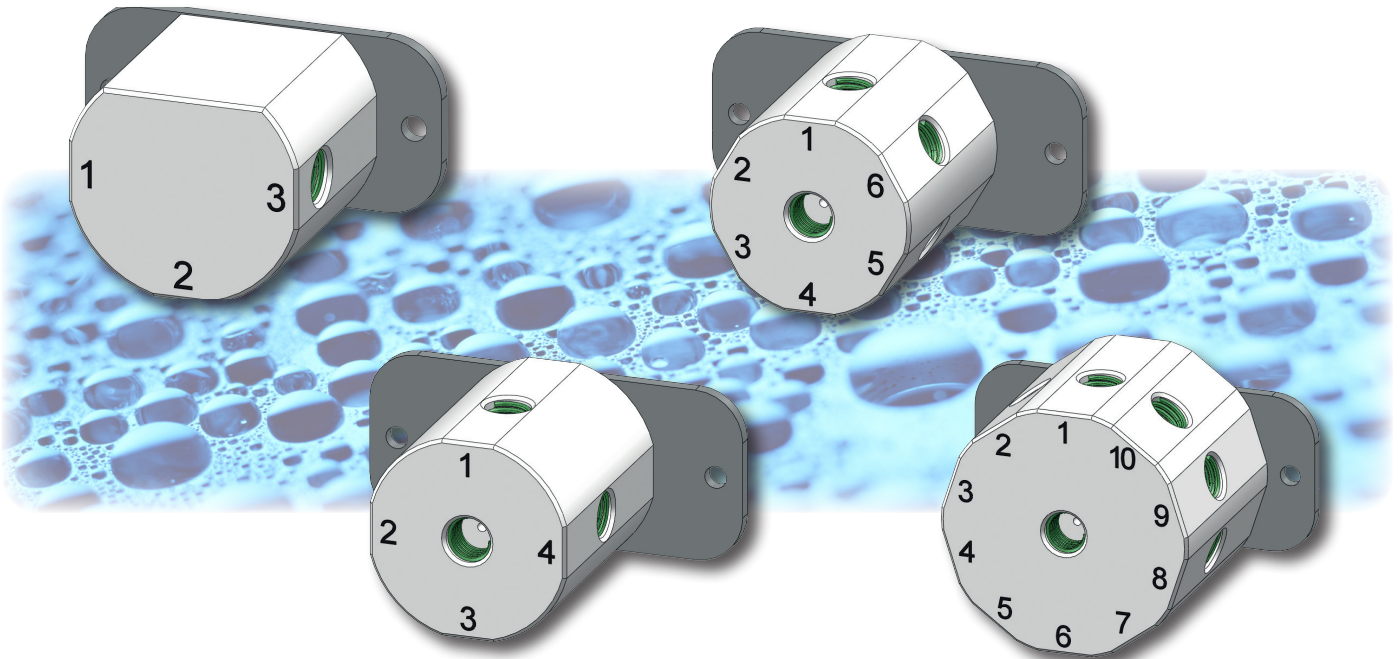

## *Low Pressure Valve Series S 6800*

- ◆ ***Chemically Inert (PTFE-TM/PCTFE)***
- ◆ ***Suitable for Aggressive Media***
- ◆ ***Maintenance Free***
- ◆ ***Custom OEM Configurations***

## S 681x 3/2-Way LP Valve

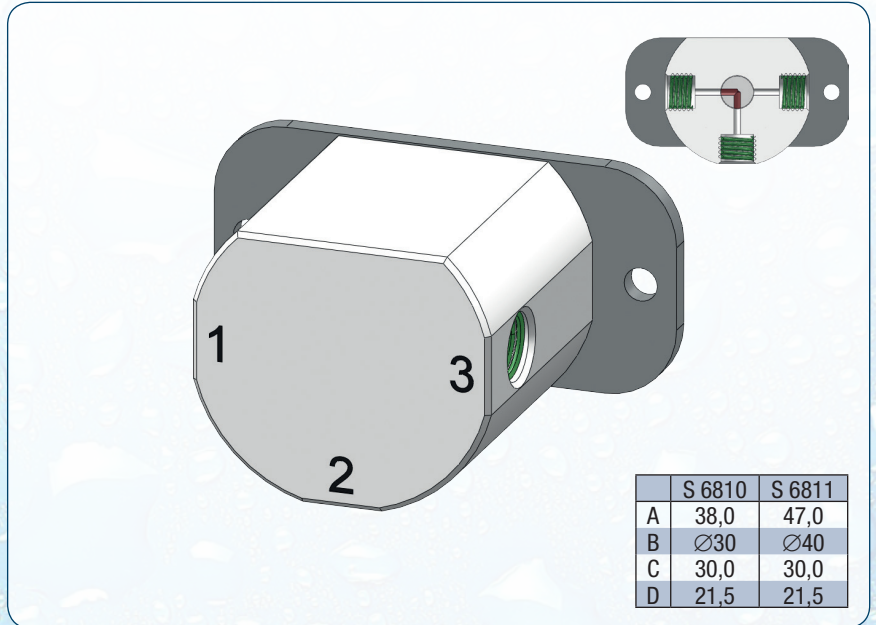
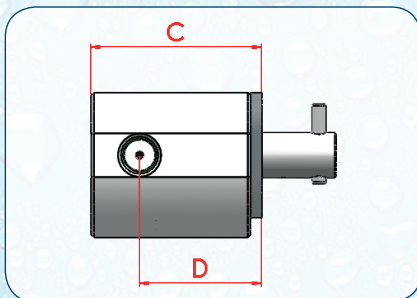
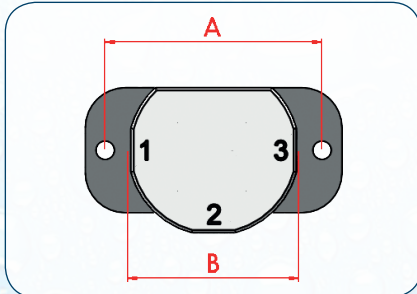

	S 6810	S 6811
A	38,0	47,0
B	∅30	∅40
C	30,0	30,0
D	21,5	21,5

Cat. No.	Article	Pressure	Connection	List Price
S003328	S 6810 Valve	≤ 10 bar	1/4"-28 UNF (1/16" tubing)	96,00 €
S003598	S 6811 Valve	≤ 10 bar	M8 (1/8" tubing)	96,00 €

## S 683x 4-Pos Selection LP Valve

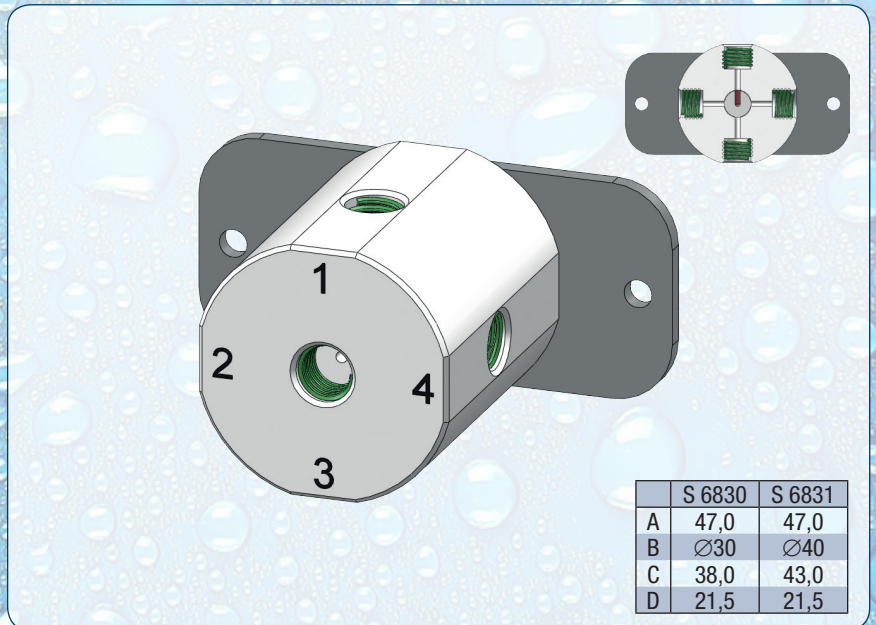
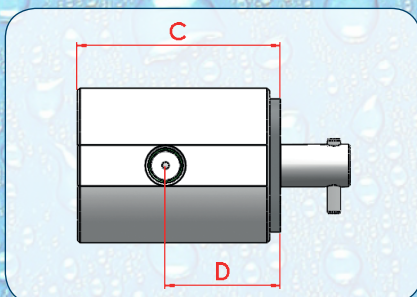
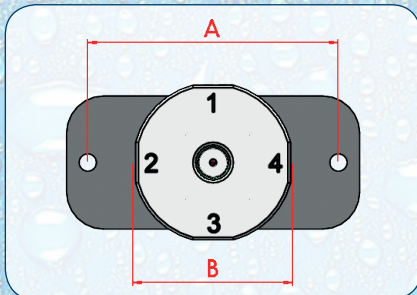

	S 6830	S 6831
A	47,0	47,0
B	∅30	∅40
C	38,0	43,0
D	21,5	21,5

Cat. No.	Article	Pressure	Connection	List Price
S003339	S 6830 Valve	≤ 10 bar	1/4"-28 UNF (1/16" tubing)	99,00 €
S003599	S 6831 Valve	≤ 10 bar	M8 (1/8" tubing)	99,00 €

## S 684x 6-Pos Selection LP Valve

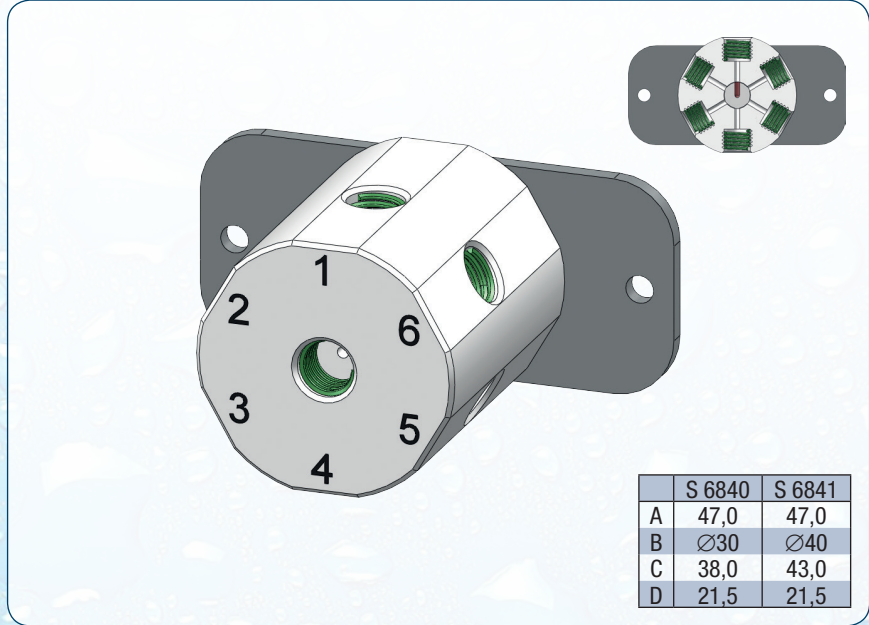
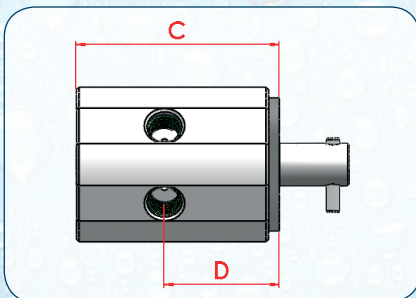
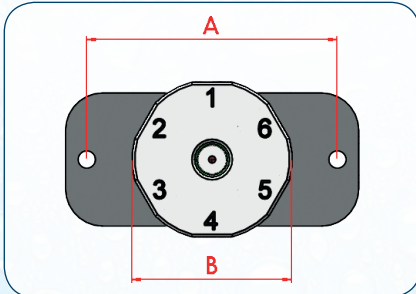

	S 6840	S 6841
A	47,0	47,0
B	∅30	∅40
C	38,0	43,0
D	21,5	21,5

Cat. No.	Article	Pressure	Connection	List Price
S003340	S 6840 Valve	≤ 10 bar	1/4"-28 UNF (1/16" tubing)	102,00 €
S003600	S 6841 Valve	≤ 10 bar	M8 (1/8" tubing)	102,00 €

## S 688x 10-Pos Selection LP Valve

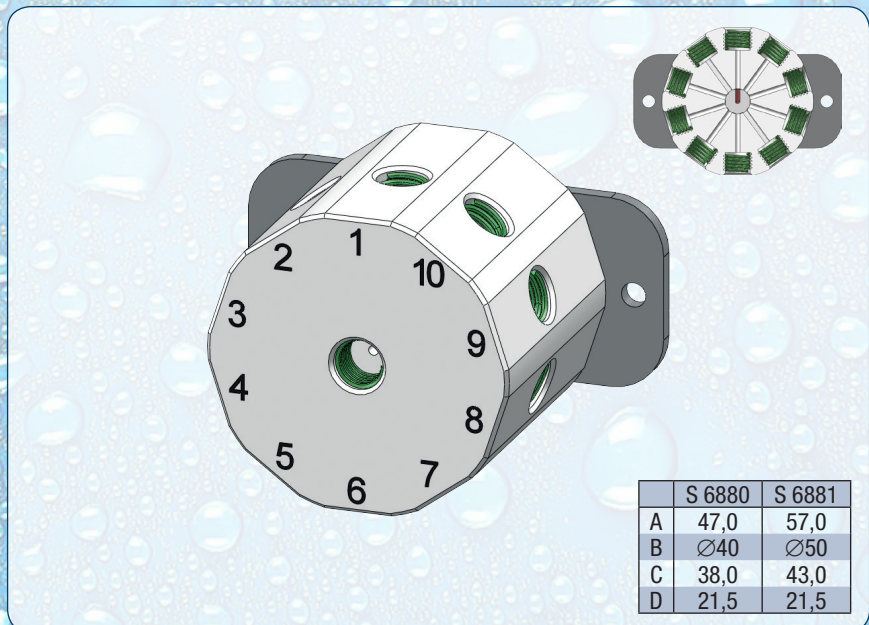
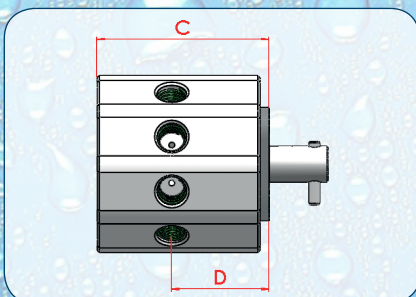
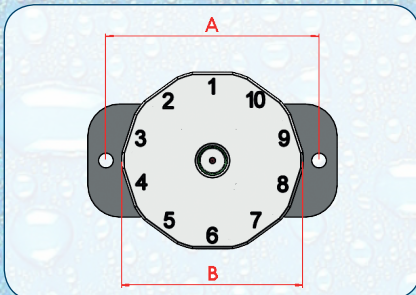

	S 6880	S 6881
A	47,0	57,0
B	∅40	∅50
C	38,0	43,0
D	21,5	21,5

Cat. No.	Article	Pressure	Connection	List Price
S003341	S 6880 Valve	≤ 5 bar	1/4"-28 UNF (1/16" tubing)	168,00 €
S003601	S 6881 Valve	≤ 5 bar	M8 (1/8" tubing)	168,00 €

## S 6800 Accessories

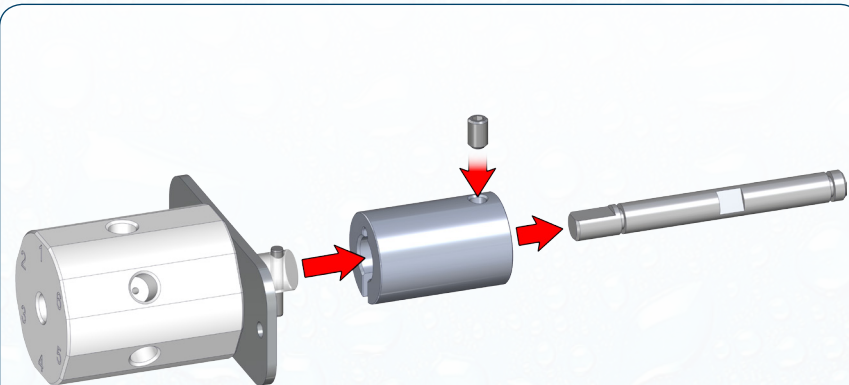

- Asymmetric coupling
- Easy mounting and exchange
- No wrong mounting of valve

Cat. No.	Description	Notes	List Price
S003603	Fingertight Fitting for 1/16" tubing (10 pcs.)	1/4"-28 UNF Connection; PVC gray	39,00 €
S003605	Fitting for 1/16" tubing (10 pcs.)	1/4"-28 UNF Connection; PVC gray	39,00 €
S003607	Ferrule for 1/16" tubing (10 pcs.)	PTFE TM	30,00 €
S003609	Fingertight Fitting for 1/8" tubing (10 pcs.)	M8 Connection; PVC gray	39,00 €
S003613	Fitting for 1/8" tubing (10 pcs.)	M8 Connection; PVC gray	39,00 €
S003611	Ferrule for 1/8" tubing (10 pcs.)	PTFE TM	30,00 €
S003621	Axis Coupling	for 6mm Motor axis	22,00 €

**Chemically Inert:** The only wetted materials are PTFE TM and PCTFE, both highly inert materials. The valve rotor and valve body is suitable for aggressive media without degradation of the valve or the transported liquid.

**Maintenance Free:** The robust design needs no sealing parts and is therefore maintenance free.

**OEM Solutions:** The Low Pressure Valve Series S 6800 is available in different standard configurations.

### Sykam GmbH

Systeme & Komponenten analytischer Meßtechnik

Gewerbering 15  
86922 Eresing  
Germany

Tel.: +49 (8193) 93 82 - 0

FAX: +49 (8193) 93 82 - 20

E-Mail: [Info@sykam.com](mailto:Info@sykam.com)

Web: <http://www.sykam.com>

**SYKAM**  
CHROMATOGRAPHY

Customer specific configurations are available on request.